

**1400/F1400 SERIES  
MORTISE LOCK EXIT DEVICE**

**INSTALLATION INSTRUCTIONS**

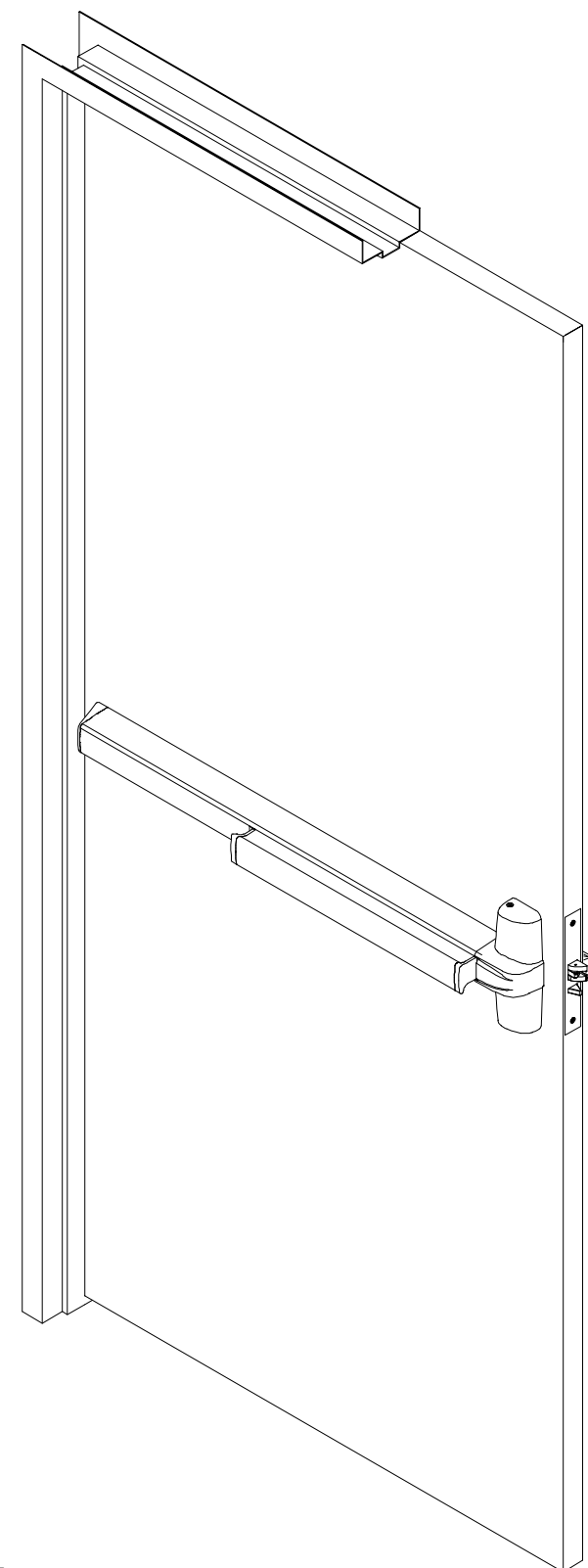

Patent No. 7,634,927 7,748,757  
D623,499 7,836,738 7,887,107  
and other patents pending.

WD-OD002(337)

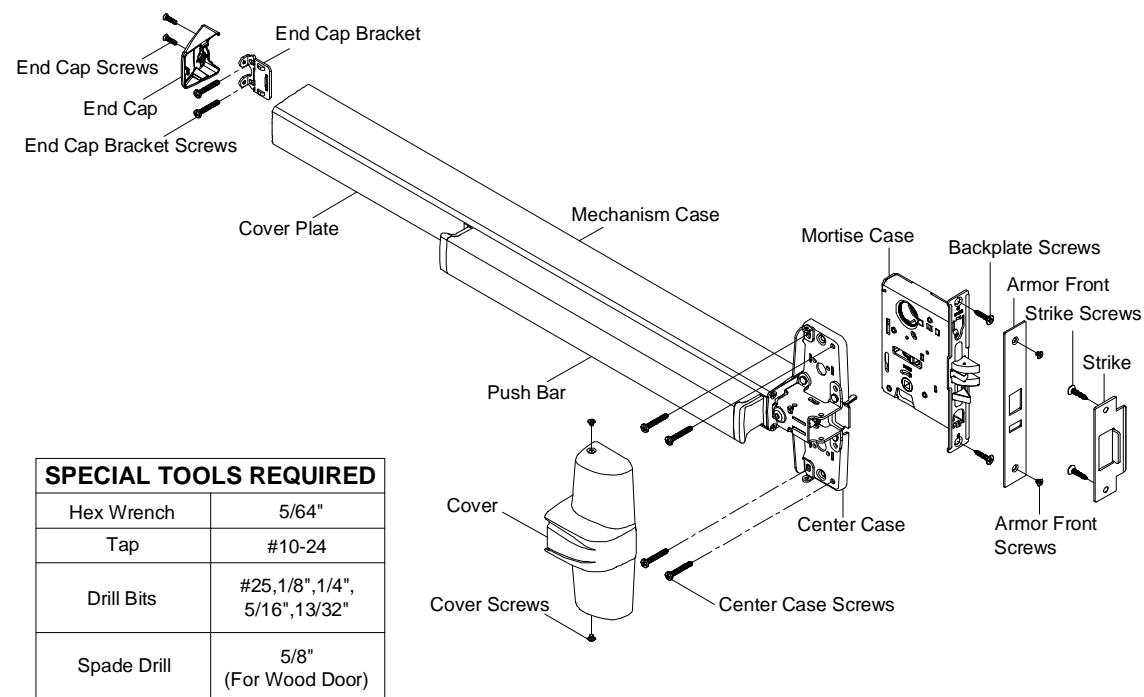

SPECIAL TOOLS REQUIRED	
Hex Wrench	5/64"
Tap	#10-24
Drill Bits	#25, 1/8", 1/4", 5/16", 13/32"
Spade Drill	5/8" (For Wood Door)

### SCREW CHART

APPLICATION	METAL	SEX BOLTS	WOOD
 Center Case Screws	 No. 10-24 x 1-11/32" 4 PCS	 No. 10-24 x 1-11/32" 4 PCS  No. 10-24 x 1-3/32" 4 PCS	 No. 10-12 x 1-11/32" 4 PCS
 End Cap Bracket Screws	 No. 10-24 x 1-11/32" 2 PCS	 No. 10-24 x 1-11/32" 2 PCS  No. 10-24 x 1-3/32" 2 PCS	 No. 10-12 x 1-11/32" 2 PCS
 End Cap Screws	 No. 8-32 x 5/8" 2 PCS		
 Cover Screws	 No. 8-32 x 5/32" 2 PCS		
 Cylinder Screws	 No. 10-24 x 1-11/32" 2 PCS		
 Backplate Screws	 No. 12-24 x 7/8" 2 PCS		
 Armor Front Screws	 No. 8-32 x 5/32" 2 PCS		
 306 / 336 / 337 / 338 Strike Screws	 No. 12-24 x 7/8" 2 PCS		

## DOUBLE CYLINDER INSTALLATION

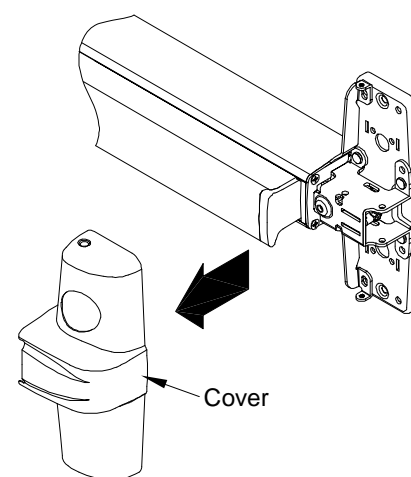

1. Remove cover.

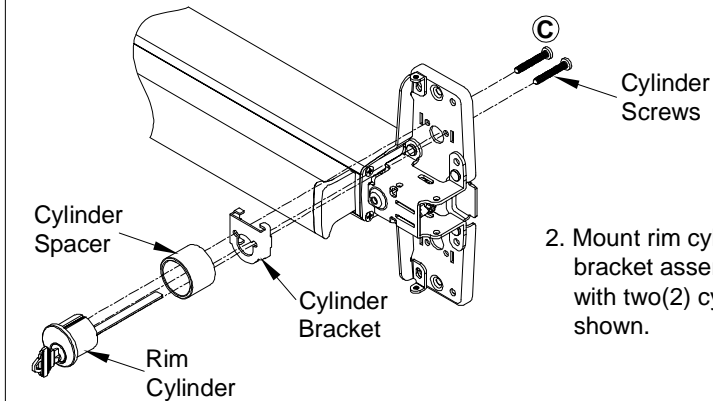

2. Mount rim cylinder to cylinder bracket assembly to center case with two(2) cylinder screws as shown.

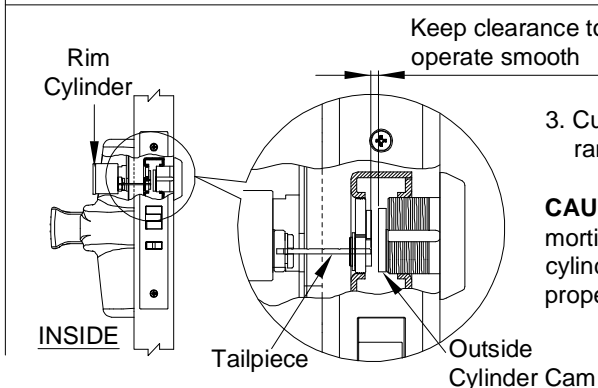

3. Cut off tailpiece for different door ranges and various cylinder lengths.

**CAUTION!** If the tailpiece is too far into mortise case and interferes with outside cylinder cam, both cylinders cannot be properly operated.

## CUT DEVICE (IF REQUIRED)

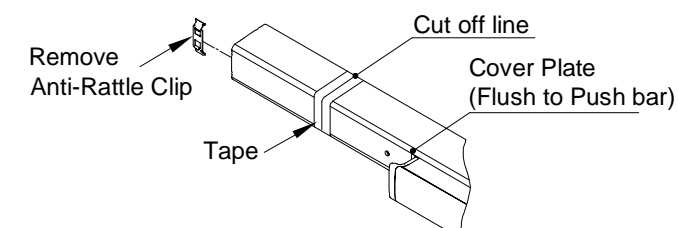
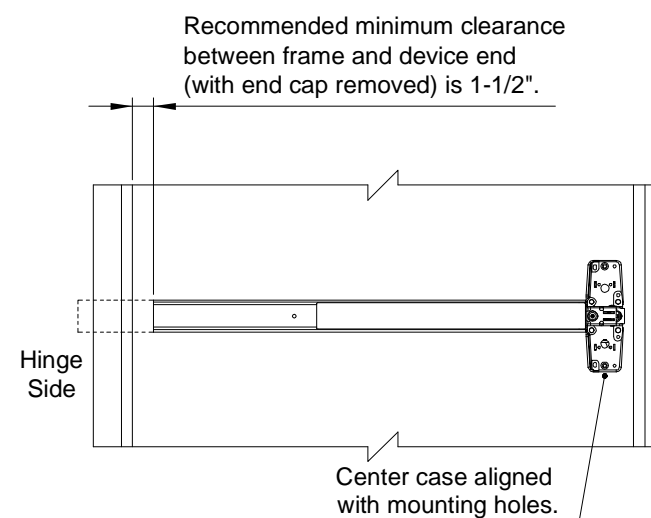

1. With anti-rattle clip removed, tape and mark area being cut.

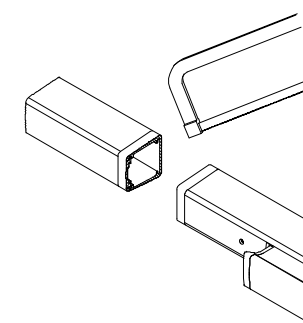

2. Cut off device and deburr.  
**NOTE:** Device must be cut square for proper end cap fit.

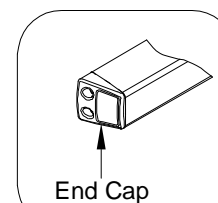

9 ADJUSTING LATCH BOLT.

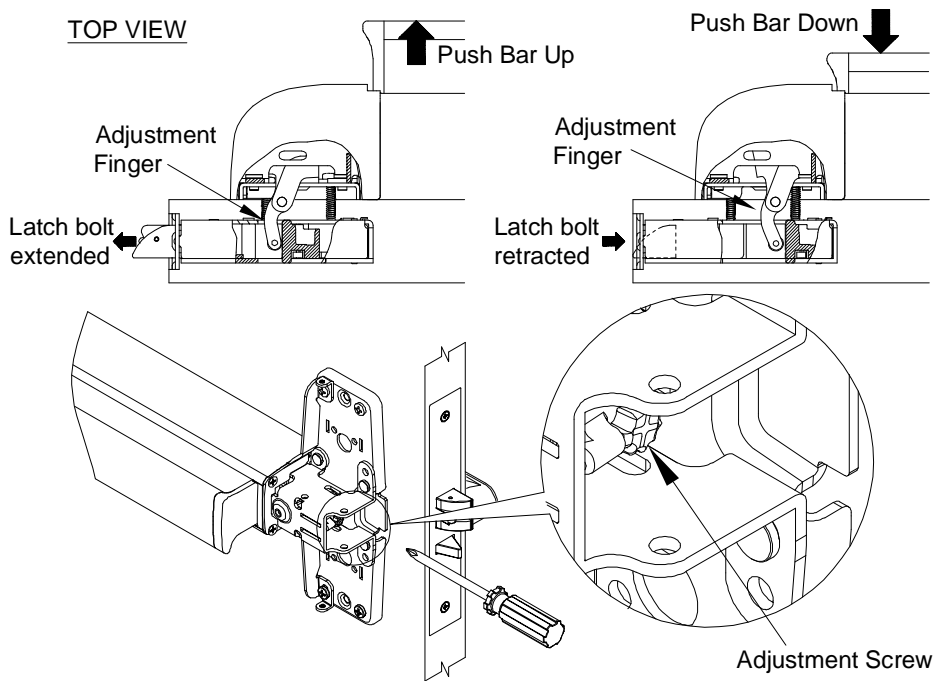

Latchbolt should be fully retracted when push bar is depressed or device is dogged down. If above condition does not exist, adjust "adjustment finger" with adjusting "adjustment screw".

10 INSTALL CASE COVER.

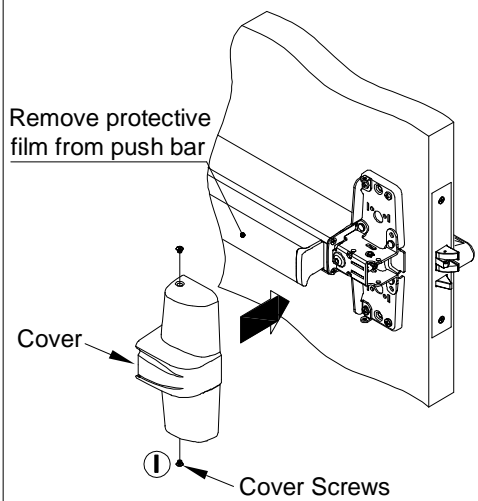

Attach cover to center case with two(2) center case screws.

OPTIONAL DOGGING

CYLINDER DOGGING

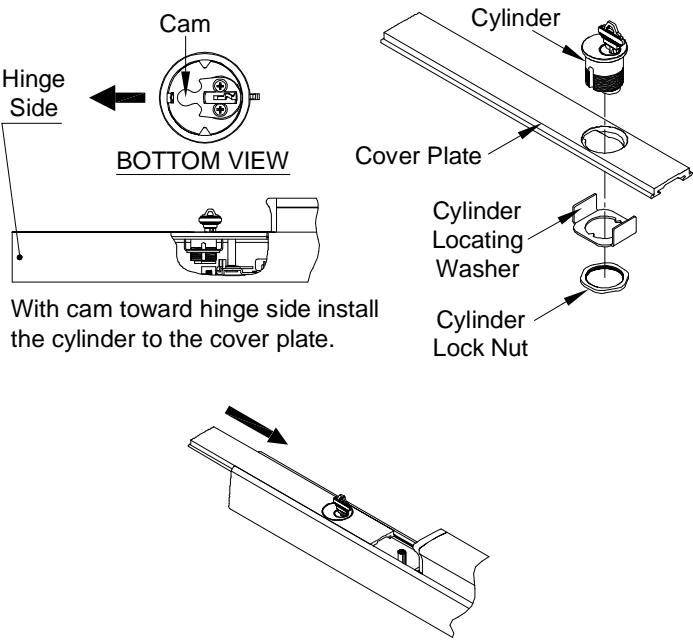

With cam toward hinge side install the cylinder to the cover plate.

Slide cover plate in position in the mechanism case.

DOGGING CHECK

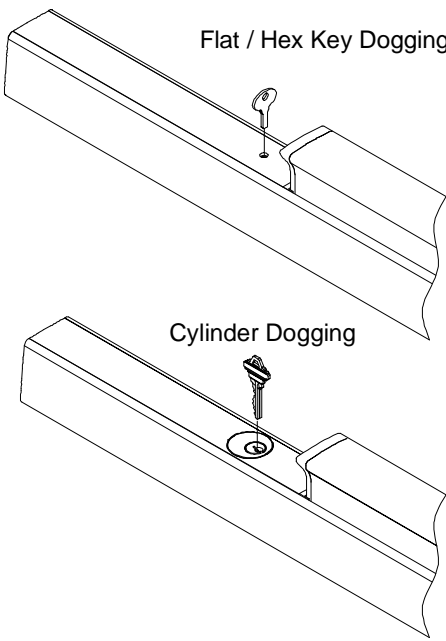

Depress push bar and turn flat / hex wrench or key one full turn for dogging check.

DOOR PREPARATION CHART

RHR shown (LHR opposite)

CENTER CASE - 4 HOLES	
SURFACE MOUNT	SEX BOLTS OR TRIM
<b>METAL</b>	<b>METAL</b>
#25 DRILL #10-24 TAP	1/4" DRILL (DEVICE SIDE) 13/32" DRILL (TRIM SIDE)
<b>WOOD</b>	<b>WOOD</b>
1/8" DRILL PILOT 1" DEEP	13/32" DRILL THRU

END CAP BRKT. - 2 HOLES	
SURFACE MOUNT	SEX BOLTS
<b>METAL</b>	<b>METAL</b>
#25 DRILL #10-24 TAP	1/4" DRILL (DEVICE SIDE) 13/32" DRILL (TRIM SIDE)
<b>WOOD</b>	<b>WOOD</b>
1/8" DRILL PILOT 1" DEEP	13/32" DRILL THRU

\*PREPARE HOLES AFTER LOCK SIDE OF DEVICE IS MOUNTED AND HINGE SIDE OF DEVICE IS LEVELED

STRIKE PREPARATION

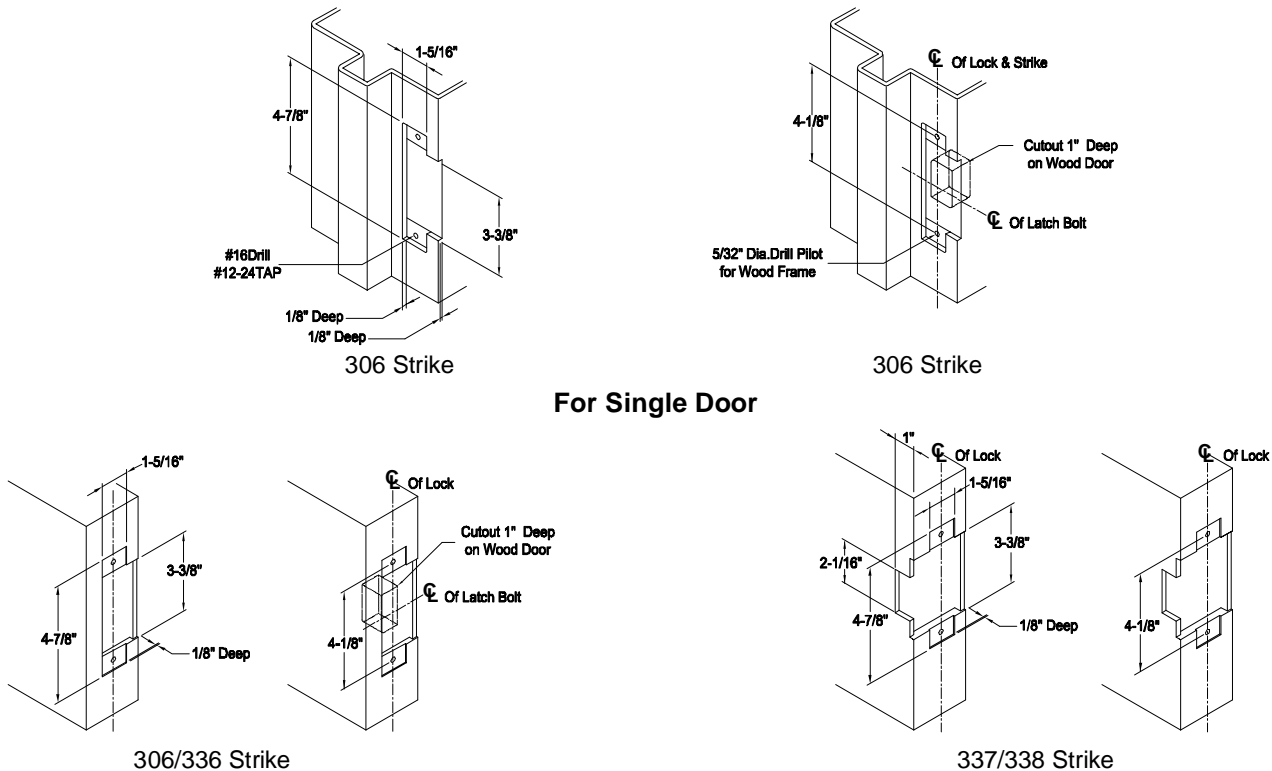

For Single Door

For Double Door

# 1 DRAW HORIZONTAL DEVICE CENTERLINE (☒).

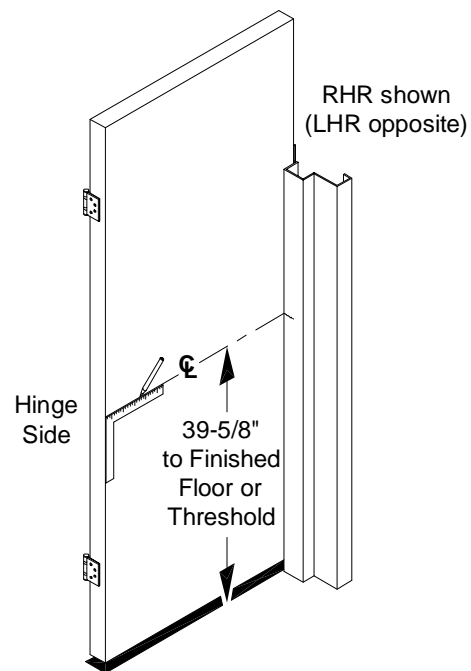

Close door, mark horizontal centerline on inside face of door and on lock side door stop 39-5/8" from finish floor as shown, (Continue horizontal centerline to outside face of door if trim is used)

# 2 ALIGN TEMPLATE ALONG CENTERLINE (☒) AND MARK DOOR.

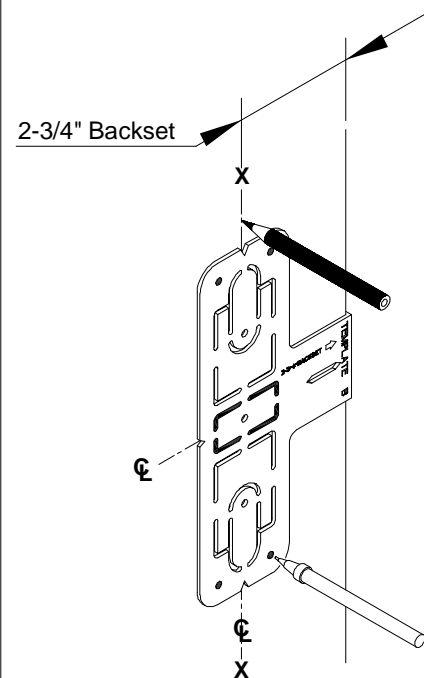

Mark four(4) center case holes. Mark vertical centerline at lock side using 2-3/4" backset dimension.

# 3 PREPARE FOUR(4) CENTER CASE HOLES AND MORTISE LOCK CUTOUTS.

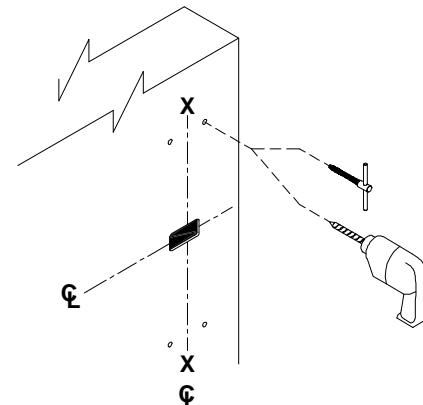

3A. Mark vertical centerline at lock side using 2-3/4" backset dimension (If trim is using mark vertical centerline on the outside face of door. Use extra care if edge of door is beveled, be sure X-X vertical centerline is parallel to edge of door).  
3B. If door is not pre-machined for mortise lock, mortise the door according to "Mortise Lock Instructions".

See "Trim Instructions" for pull side door preparation.

# 4 INSTALL MORTISE LOCK INTO DOOR.

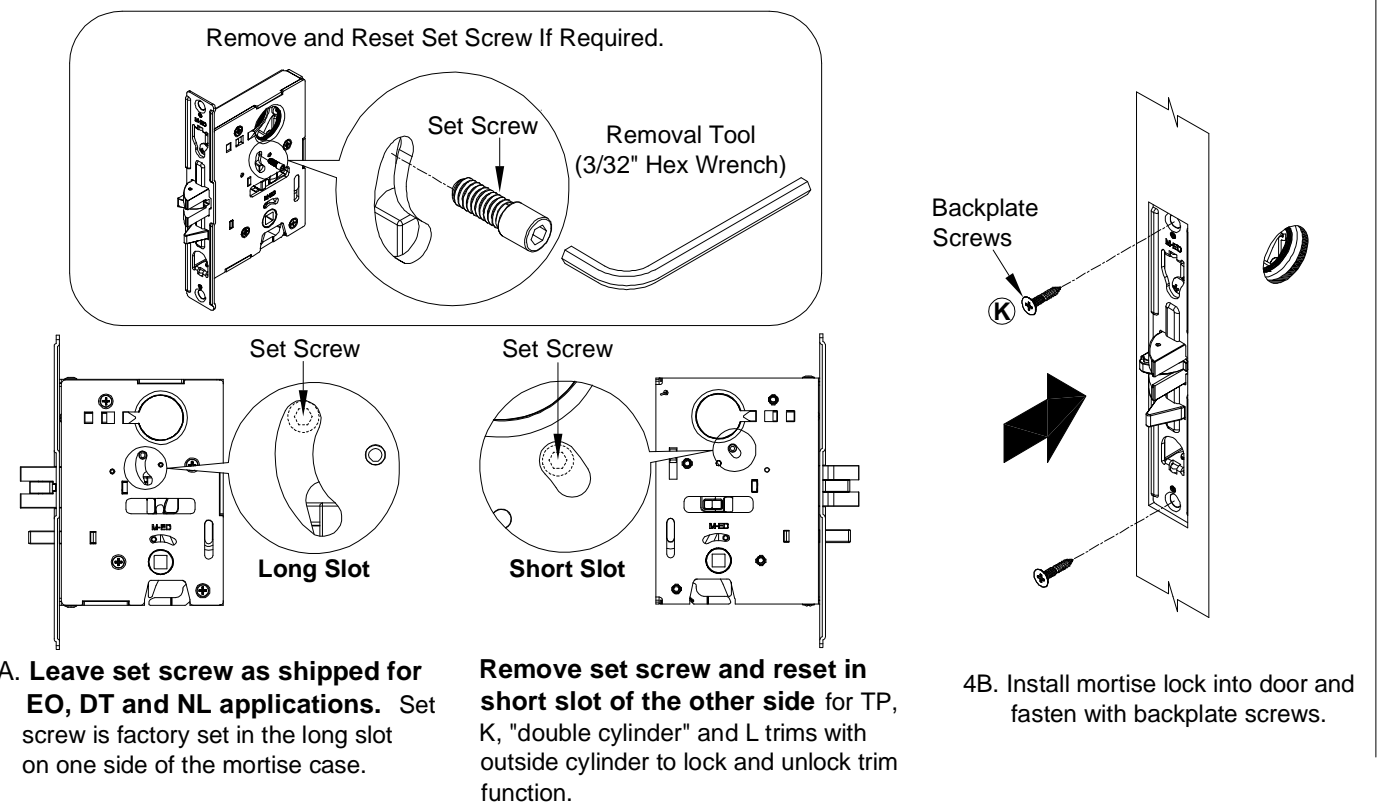

# 5 INSTALL TRIM (IF USING) AND SECURE DEVICE CENTER CASE TO DOOR.

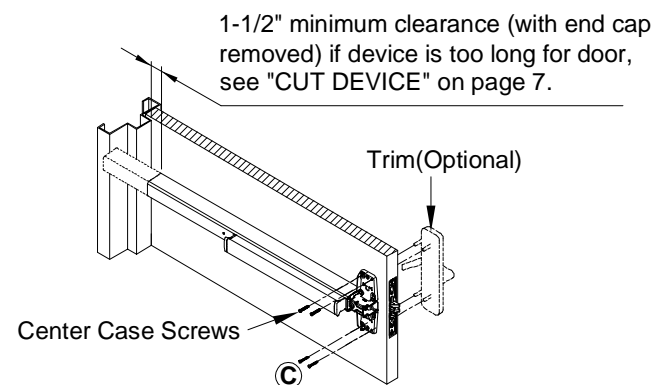

1. DEVICE WITH TRIM - See "Trim Instructions".  
2. EXIT ONLY - With device adjustment finger in the mortise case, mount center case to the door with four(4) screws.

## For FIRE EXIT DEVICES

Sex bolts and support screws are required for composite (wood, plastic and steel covered), wood core, sheet metal and hollow metal doors without reinforcement unless door manufacturer has an alternate mounting method. Fire doors with steel reinforcement, mount devices with machine screws

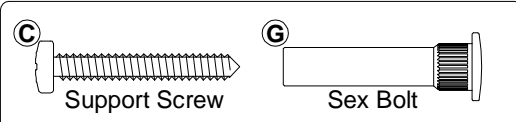

# 6 INSTALL OUTSIDE LOCKING CYLINDER (IF USING) AND FINISH INSTALLING MORTISE LOCK.

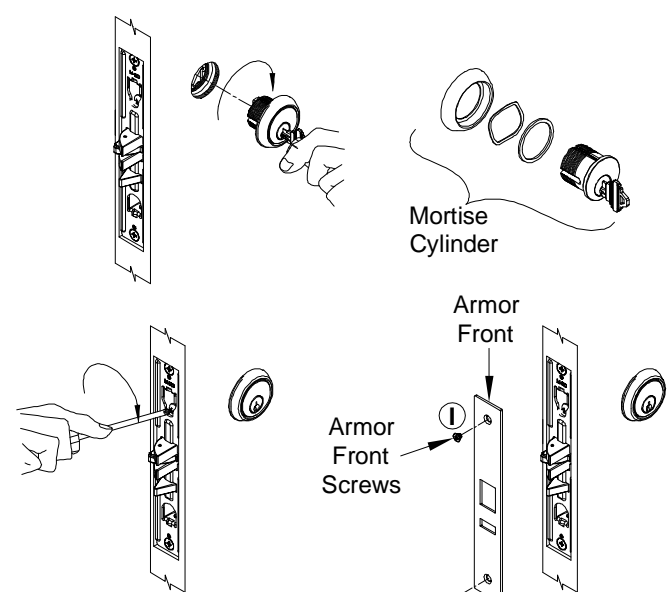

CYLINDER ONLY - Install mortise cylinder into mortise lock as shown. Check key operation and secure cylinder in place by tightening cylinder anchor screw into groove on side of cylinder.  
**NOTE:** See "DOUBLE CYLINDER INSTALLATION" on page 7 for double cylinder application.

# 7 INSTALL SUPPLIED STRIKE TO FRAME OR OTHER DOOR.

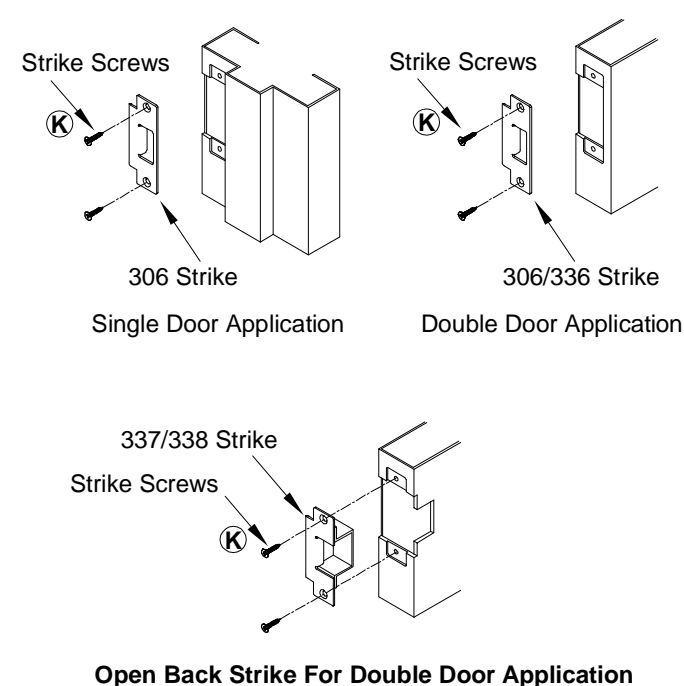

See "STRIKE PREPARATION" on page 3 for preparation information.

# 8 INSTALL MOUNTING BRACKET AND END CAP.

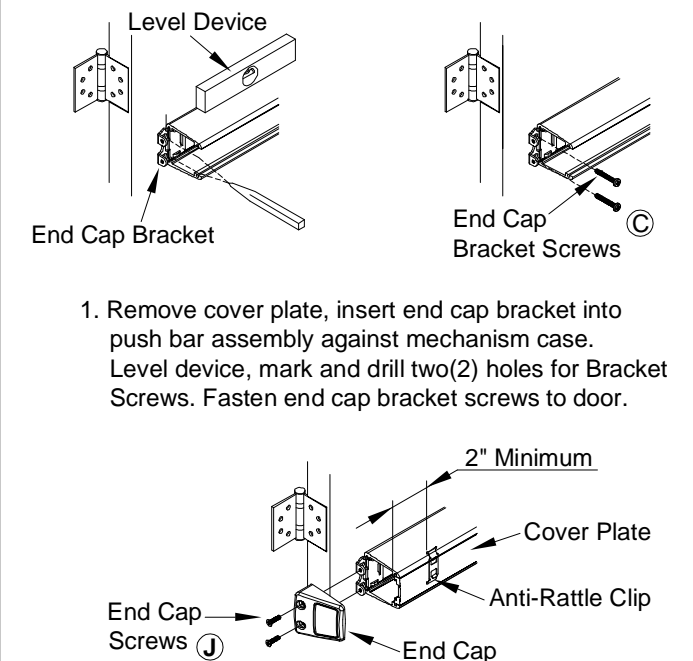

2. Insert cover plate, slide anti-rattle clip in position (2" minimum from end), and attach end cap with two(2) end cap screws.